



Friendly to users. And the environment.

With great features to enhance productivity and elevate efficiency in work environment, the new Fuji Xerox DocuPrint C1190 FS has been designed to benefit even non-users. In line with our Corporate Social Responsibility commitment, we have taken great care to ensure that the DocuPrint C1190 FS also cares for the natural environment.

Makes economical and ecological sense.

As well as making the DocuPrint C1190 FS affordable, we've also kept it environmental friendly by using renewable components. Like our other printers, this one is oil-free and consumes less power. Not surprisingly, it has earned energy efficient compliance – the ENERGY STAR.



Fuji Xerox EA-HG Toner
DocuPrint C1190 FS uses Fuji Xerox proprietary advanced Emulsion Aggregation (EA) toners which are chemically grown.

This process is believed to be more environmental friendly and delivers the desired small and uniformed toner particle size that will result in superior print quality and sharper images. At the same time, the innovative toner cartridge design makes toner replacement a breeze.



ENERGY STAR Qualified
To help you conserve on energy, no effort has been spared in ensuring that the DocuPrint C1190 FS complies with ENERGY STAR, whose objective is to save energy and protect the environment through energy efficient products and processes. Being ENERGY STAR compliant, the DocuPrint C1190 FS efficiently performs regular tasks with less energy. Since it often doubles as a fax machine, the DocuPrint C1190 FS would be left running after office hours. At times like these, a low power mode automatically kicks in. By saving energy, this lower greenhouse gas emission helps improve the quality of our environment.

Intuitive Control Panel

Even though it has so much to offer, mastering the DocuPrint C1190 FS is easy, thanks to the Intuitive Control Panel. Comprising a large LCD of 4 lines and 32 characters, one-touch buttons plus an alpha-numeric keypad, accessing the functions you want has never been quicker.



Specifications of DocuPrint C1190 FS

Print Function	
Print Speed (A4)	Up to 12 ppm colour and 16 ppm black & white
Print Resolution	600 x 600 dpi
First-Page-Out Time	Less than 14.4 seconds (colour) / 11.4 seconds (black & white)
Warm-up Time	Less than 30 seconds
Memory	Standard 384MB
Processor	400 MHz
PDL	PCL6, PCL5, HBPL
Connectivity	USB2.0, Ethernet 100 Base-TX / 10 Base-T
Supported Operating System	Windows Vista (32bit/64bit) / XP (32bit/64bit) / 2000 workstation and server, Server 2003 (32bit/64bit) / Server 2008 Mac OS X version 10.3.9 and higher
Input Paper Size	
Paper Tray and Manual Feeder: A4, Letter, Legal, Executive, Folio, A5, B5 JIS, #10 Envelope (4.125 x 9.5"), Monarch Envelope (3.875 x 7.5"), DL Envelope (110 x 220mm), C5 Envelope (162 x 229mm), Custom size (W76.2 - 215.9mm x L127 - 355.6mm)	
Input Paper Weight	
Paper Tray and Manual Feeder: 60 - 216gsm	
Media Input Capacity	
Paper Tray: 250 sheets; Manual Feeder: 1 sheet	
Media Output Capacity	
150 sheets face down	
Automatic Document Feeder	
35 sheets	
Dimensions (W x D x H)	
425 x 507 x 585 mm	
Weight	
Less than 25 kg (CRU not included) Less than 30 kg (CRU included)	
Power Supply	
110 - 127 VAC, 50 - 60Hz, 9A or 220 - 240 VAC, 50 - 60Hz, 5A	
Power Consumption	
Average 360W, Standby 60W, Sleep mode 18.4W	
Operating Environment	
Temperature: 10C - 32C Humidity: 15 %RH - 85 %RH	
Noise Levels	
Standby mode: Less than 4.3 B Printing mode: Less than 7.03 B	
Print Features	
Poster printing, Booklet printing (manual duplex), Secure Print, Watermark printing, Multiple-Up, Favourites	
Copy Function	
Copy Speed (A4)	Up to 12 cpm colour and 16 cpm black & white
Copy Resolution	600 x 600 dpi
First-Copy-Out Time	Less than 30.3 seconds (colour) / 21.3 seconds (black & white)
Reduction/Enlargement	25 - 400 %
Continuous Copy	99 pages
Copy Features	2-in-1 Copy, ID card Copy, Collation

Descriptions in this material, product specifications and/or appearances are subject to change without prior notice due to improvements. Please note that the product colour appears differently from the actual colour as a result of properties of papers or printing ink. Windows and Windows NT are registered trademarks of Microsoft Corporation. NetWare is a registered trademark of Novell Inc. in the United States, Macintosh, Mac OS and Ether Talk are trademarks of Apple Computer, Inc. HP-GL is a registered trademark of Hewlett-Packard Company. Other company names or product names are registered trademarks or trademarks of each company.

For Your Safe Use
Before using the product, read the Instruction Manual carefully for proper use.
Use the product with an appropriate adequate power source and voltage displayed. Be sure to establish a ground.
In the case of a failure or short circuit, an electric shock may result.

For more information or detailed product specifications, call or visit us at:

Fuji Xerox Asia Pacific Pte. Ltd. (993478A)
(Fuji Xerox Printers)
Wisma Fuji Xerox,
1st Floor, No. 10, Jalan Bersatu 13/4,
46200 Petaling Jaya,
Selangor, Malaysia.
Tel: 03-7882 2888 Fax: 03-7882 2767

East Malaysia Office:
199A-201, Lot 3049 & 3050,
Eastmoore Centre,
2 1/2 Mile, Jalan Rock,
93200 Kuching,
Sarawak, Malaysia.
Tel: 082-428 650 Fax: 082-418 733

Service Hotline : 1800 88 1063
www.fujixeroxprinters.com.my

XEROX and Use sphere of connectivity design are trademarks or registered trademarks of Xerox Corporation in the U.S. and/or other countries. Apertio is a trademark or registered trademark of Fuji Xerox Co. Ltd. Other trademarks are the property of their respective owners.

Scan Function	
Type	Color Flatbed CCD
Original Paper Size	Platen : 215.9 x 297 mm, ADF : 215.9 x 355.6 mm
Scanning Resolution	600 x 600 dpi
Scan Destinations	Scan to Application, Scan to Email, Scan to Network (FTP / SMB)
Bundled Software	DocuWorks 6.2 Special Edition
Fax Function	
Memory Capacity	4MB
Fax Resolution	Up to 400 x 400 dpi
Transmission Speed	Up to 33.6 Kbps (Super G3)
One-Touch/ Speed Dials	8/200
Fax Features	DirectFAX, Delay start, Junk fax filter, Secure receive
Consumables	
Toner Cartridge Black (up to 3,000 pages*)	CT 201260
Toner Cartridge Cyan (up to 3,000 pages*)	CT 201261
Toner Cartridge Magenta (up to 3,000 pages*)	CT 201262
Toner Cartridge Yellow (up to 3,000 pages*)	CT 201263
Fuser Unit 220V (up to 50,000 pages*)	EL300689
Feed Roller Unit (up to 50,000 pages*)	EL300767
PHD (up to 20,000 pages*)	CT350795

*Declared yield in accordance with ISO/IEC 19798. Yield may vary depending on image, area, coverage and print mode (job length, media size, media type and orientation). Printer is shipped with one set of starter toner cartridge with an average yield of about 1,000 pages for Black and about 1,000 pages for Cyan, Magenta, Yellow.



Reproduction Prohibitions Please note that reproduction of the following is prohibited by law. Domestic and overseas bank notes and coins, government issued securities, national bonds and local bond certificates, unused postage stamps and post cards. Certificate stamps stipulated by law. The reproduction of works for copyright purposes (literary works, musical works, paintings, engravings, maps, cinematographic works, photographic works, etc.) is prohibited except when they are reproduced personally, at home or within limited range according to the above. This product is equipped with an anti-counterfeit feature. This feature is not intended to prevent illegal reproduction. Be extremely careful about the management of equipment used.



DocuPrint
C1190 FS



DocuPrint C1190 FS

Colour Multifunction Printer

Brilliant Simplicity for Delightful Results

Affordable 4-in-1 colour solution



Compact, dependable and powerful A4 colour laser multifunction device that runs at 12ppm in colour!

The new Fuji Xerox DocuPrint C1190 FS is an entry-level, A4-sized, colour laser multifunction that may be small in size. But is definitely big on features. In colour, it prints and copies 12 pages a minute, and speeds up to 16 pages a minute for the same in Black and White. With its competitive processing speed, compact design, high performance and affordable dependability, it's no wonder the DocuPrint C1190 FS will make its way into many Small Office, Home Office.

4-in-1 for everyone

From basic printing to copying, from scanning to faxing, everything is at your fingertips if you have the DocuPrint C1190 FS.

Laser sharp printing that gives you the edge

Business is all about making the right impression. And with the network ready and USB2.0 compatible DocuPrint C1190 FS, you'll definitely look sharp. Since time is money, it comes with a powerful 400MHz processor and features a 384MB memory that shortens processing time and prints documents in high quality – so printing 12 pages per minute in colour (16ppm in B&W) is easily achieved. A 250-sheet paper tray completes large print jobs with less re-loading. Fewer pit-stops means greater efficiency.



The copier that takes the lead

Supported by a 35-sheet Automatic Document Feeder, the DocuPrint C1190 FS easily churns out 12cpm (colour) and 16cpm (B&W), making it one of the fastest in its class. Getting the bigger picture is also easy thanks to the 25% to 400% reduction/enlargement. Our ID Copy feature makes cost efficiency easier to achieve. Now, both sides of a small-sized document can be automatically fitted onto the same side of an A4-page quickly.

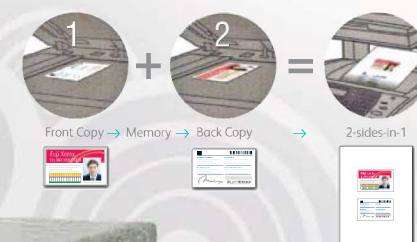

Laser faxing that sends a clear message

Faxes may not be as warp speed as sending Email messages. However, when you just have to fax, the DocuPrint C1190 FS rises to the challenge. For speed, it supports up to Super G3 fax. Sending multiple faxes has never been easier. With 200 speed dials, 6 group dials and 8 one-touch dials, Workgroup faxing is now at your fingertips. Our DirectFAX even lets you send faxes directly from PC without the need for additional software. And with SecureFax Receive, you can safely share the fax machine - without sharing sensitive information.

Colour scanning that helps you stand out

Inside every Fuji Xerox DocuPrint C1190 FS is a CCD scanner to ensure high scan quality. By using such advanced image sensing technology, colour scanning up to 9600dpi enhanced resolution is easy. Further improve the document flow in your office and speed up work with intelligent functions such as Scan to Email (Direct without PC) or Network Scan to FTP/SMB.



Greater connectivity for smoother work efficiency

Without doubt, the DocuPrint C1190 FS is a wonderful 4-in-1 machine. However, it is not just another multifunction device. It is a complete office productivity solution. With integrated functions and specifications, DocuPrint C1190 FS accelerates office operations and improves office efficiency.

a. Secure Print and Fax Receive

No matter how open an organization is, there will be some information that is just too sensitive to be shared with all. With the "Secure Print and Fax Receive" feature, the DocuPrint C1190 FS lets you use passwords to stop confidential faxes and print-outs from becoming open secrets.



b. DirectFAX

In business, every second and every cent count. Now, you can save time by sending a fax to anyone anywhere without walking to the fax machine thanks to our DirectFAX feature. It conveniently lets you fax directly from your PC, so you do not have to print out a hard copy just to send a fax, which makes it more economical.



c. Scan to E-mail (without PC)

Now, you can command the DocuPrint C1190 FS to send anything it has scanned directly to a designated Email address. By cutting down on the number of steps, this machine helps you save time and stay competitive.

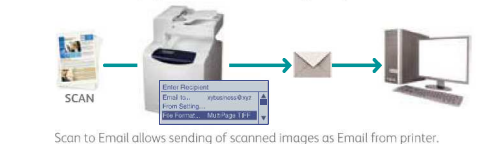

d. Network Scanning

The DocuPrint C1190 FS does more than just scan quickly and easily. It also makes document-sharing within organizations simpler and faster. For instance, you can scan directly to FTP server or SMB (network folder).

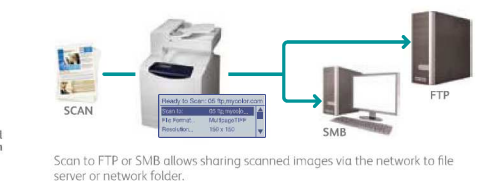

e. Remote Printer Monitor

With the SimpleMonitor software that automatically displays printer and print job status, you can now find out if something has been printed without walking to the machine. The DocuPrint C1190 FS also supports CentreWare Internet Services, thus allowing administrators to configure and monitor the status of the printer via the web browser.

